

We take your calf's health seriously



Introducing the **Surecheck 4™** CALFSCOURS TEST

- No guessing
- No waiting
- No postmortem analysis on dead calf tissue

Not only does Acepasis™, LLC provide the #1 calf hygiene program, we now offer a breakthrough technology that allows you to identify the infectious causes of calf scours and do it on-farm within minutes!

Surecheck 4™ is a lateral-flow immune-assay which enables four common causes of calf scours to be quickly and reliably identified. Surecheck 4™ is highly sensitive and highly specific to the four infectious organisms: Rotavirus, Coronavirus, E. coli, and Cryptosporidium.

Knowing the infectious source allows you and your veterinarian to outline the best practices program to better manage your calves' health. You no longer need to wait for lab results to initiate an effective calf treatment program. No guessing and no waiting!

Imagine the savings to your calf raising operation! Immediate information. A correctly identified treatment program. Healthier calves. More productive replacements.

Surecheck4™

Testing

1. Take a test cassette out of the protective pouch.
2. Shake the test bottle once more.
3. Break the pin off the lid of the test bottle.
4. Apply 3-4 drops of the sample fluid into each of the sample wells.

NOTE: Ensure that no large particles enter the sample wells; they may prevent the necessary migration of the liquid. Use the pipette to remove any such particles from the well and press the tip of the pipette directly into the well to activate migration of the liquid. An additional drop of sample fluid added to the well aids migration up the test strip.

Reading the Test

The results of the test can be read after 10 minutes.

Positive result: Two red lines appear in the reaction field. Heavy and faint test lines both indicate a positive result.

Negative result: Only the control lines appear in the reaction field. No test lines are visible.

NOTE: If there is a high concentration of antigens in the sample, the test line may appear very heavy, with only a very faint control line. This is a valid positive result.

Invalid result: If no control line is visible after the test has been performed, the test is invalid. In this case, the test might not have been carried out properly, the expiration date has already passed, or the test was exposed to ambient air outside the sealed pouch for too long.

Test Performance

	Sensitivity	Specificity
Rotavirus	96.4%	95.5%
Coronavirus	100%	100%
<i>Escherichia coli</i>	88.9%	100%
<i>Cryptosporidium parvum</i>	100%	95.9%

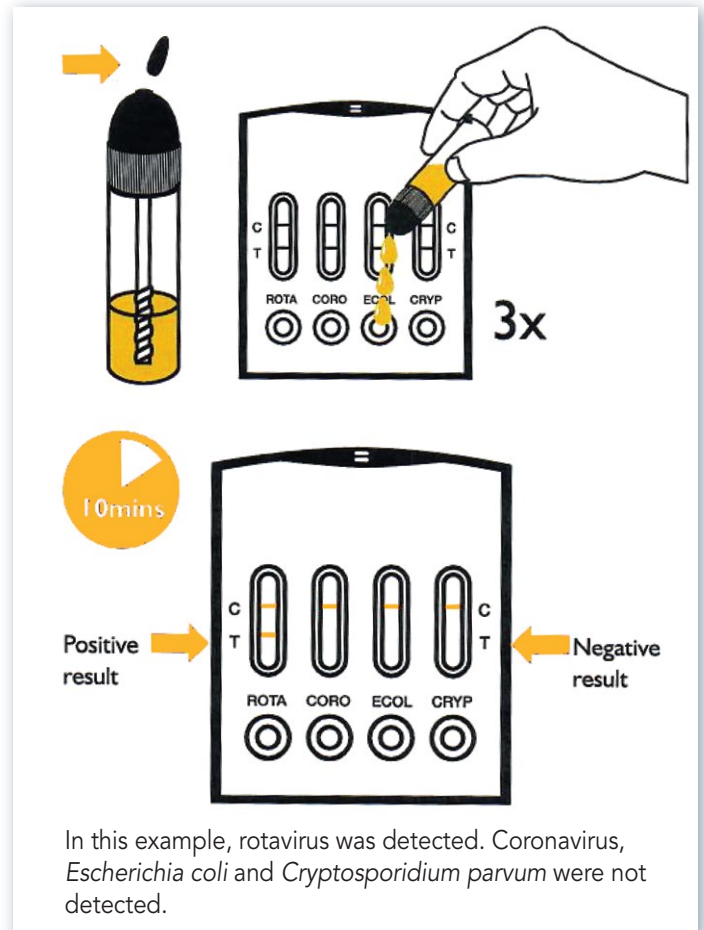

Storage

- The test must remain in the sealed pouch until it is used
- The kit should be stored at 36 - 86° F (2 - 30° C)
- Do not use after the expiry date printed on the sealed pouch

Warnings

- To be used only once
- Use the test cassette within 10 minutes of pouch opening
- Use a new test bottle for each sample to avoid cross reactions
- Do not touch the reaction field
- Use only the original Surecheck 4™ reagent provided in the kit

For more information, call **Acepsis™** or your local representative.    

ACEPSIS™, LLC is an animal health based company that is focused on the development of state-of-the-art animal hygiene technologies. Our Company's mission is to apply innovative animal hygiene technologies into the agricultural and veterinary market sectors. Visit us at www.acepsis.com.